

WINTER WARMUP 2024

COUNTERSINKS | 3 FLUTE

METRIC | COBALT M35 | TiN COATED



This highly productive countersinking cutter is a much improved version of the traditional multiflute milling cutter:

- wide flutes provide good chip evacuation
- positive cut
- constant profile aids regrinding of the tool
- self-centering of the cutting mill (three bearing points)
- virtually eliminates vibration

Dimensions are adapted so as to sink 90 degree screw caps up to M12. We recommend lubricating.

Carbide:

- Diameter 12.4 to 31 = 3 flatted shanks
- Diameter 4.3 to 8.3 = cylindrical shank
- Diameter 10.4 to 31 = brazed carbide head

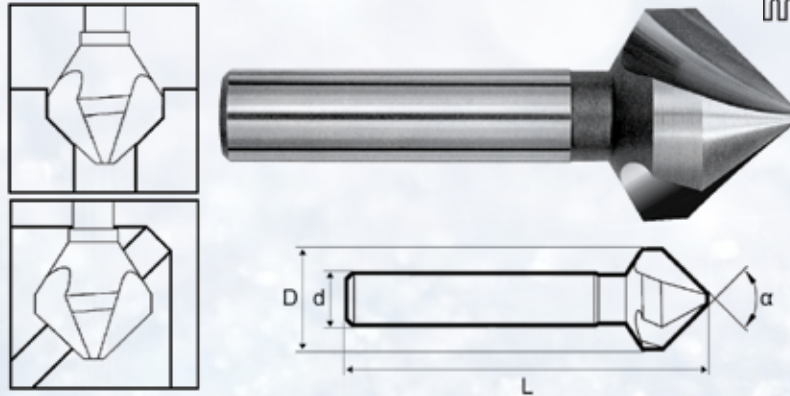

| D Overall Diameter (mm) | d Shank Diameter (mm) | Chamfer Range Min/Max (mm) | L Overall Length (Inch) | 60° Angle Series 432 | | 82° Angle Series 434 | | 82° Angle Series 4834 - TiN | | 90° Angle Series 431 | | 90° Angle Series 4831 - TiN | | 100° Angle Series 435 | | 120° Angle Series 433 | |
|----------------------------------|--------------------------------|-------------------------------------|----------------------------------|----------------------------|--------|----------------------------|--------|-----------------------------------|--------|----------------------------|---------|-----------------------------------|--------|-----------------------------|--------|-----------------------------|--------|
| | | | | Code | Price | Code | Price | Code | Price | Code | Price | Code | Price | Code | Price | Code | Price |
| 10.4 | 6 | 2.5-10.4 | 2 | 540301 | 39.69 | 540311 | 39.69 | 540361 | 38.11 | 540321 | 39.69 | 540371 | 38.11 | 540331 | 39.69 | 540341 | 39.69 |
| 16.5 | 10 | 3.2-16.5 | 2-1/4 | 540302 | 57.95 | 540312 | 57.95 | 540362 | 56.10 | 540322 | 57.95 | 540372 | 56.10 | 540332 | 57.95 | 540342 | 57.95 |
| 20.5 | 10 | 3.5-20.5 | 2-1/2 | 540303 | 65.04 | 540313 | 65.04 | 540363 | 66.01 | 540323 | 65.04 | 540373 | 66.01 | 540333 | 65.04 | 540343 | 64.04 |
| 25.0 | 10 | 3.8-25 | 2-5/8 | 540304 | 79.36 | 540314 | 79.36 | 540364 | 86.34 | 540324 | 79.36 | 540374 | 86.34 | 540334 | 79.36 | 540344 | 79.36 |
| 31.0 | 12 | 4.2-31 | 2-3/4 | 540305 | 118.01 | 540315 | 118.01 | 540365 | 112.49 | 540325 | 118.01 | 540375 | 112.49 | 540335 | 118.01 | 540345 | 118.01 |
| 40.0 | 16 | 8-40 | 4-1/2 | - | - | - | - | - | - | *540326 | 315.27 | - | - | - | - | - | - |
| 50.0 | 16 | 10-50 | 5 | - | - | - | - | - | - | *540327 | 286.71 | - | - | - | - | - | - |
| 63.0 | 16 | 10-63 | 5-1/2 | - | - | - | - | - | - | *540328 | 665.74 | - | - | - | - | - | - |
| 80.0 | 16 | 14-80 | 6-1/2 | - | - | - | - | - | - | *540329 | 1331.36 | - | - | - | - | - | - |

* Three gripping flats on shank

CONTACT YOUR LOCAL KAR DISTRIBUTOR FOR MORE DETAILS OR VISIT WWW.KAR.CA

YOUR AUTHORIZED KAR DISTRIBUTOR:

PRO CUT
INDUSTRIAL SUPPLY

780-437-2949

Toll Free: 1-866-437-2989 Fax: 780-437-2982
9806 - 45th Avenue NW, Edmonton, AB T6E 5C5

Website: www.procutindustrial.com

WINTER WARMUP

ANTI-VIBRATION COUNTERSINKS | 3 FLUTE

METRIC | COBALT M35 | 90° ANGLE | RED'X COATED



- Decreases the axial force compared to traditional countersinks, reducing tool vibrations which provides a better finish
- DIN 335-C
- The equal division 3 x 120° of the flutes offer good results in most materials
- HSSE-Cobalt (M35) with Red'X is 65 HRC, to machine steels up to 1000N/mm²
- Cast irons up to 200 HB, copper, brass, bronze, aluminum
- Red'X coating is 3500 HV and considerably increases the tool life by increasing wear resistance and improving surface finish

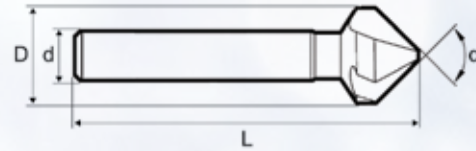
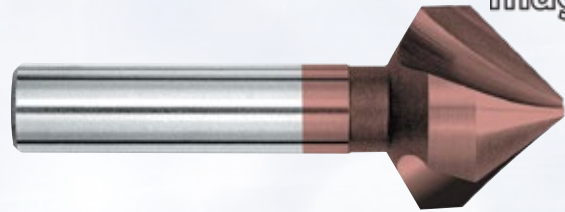
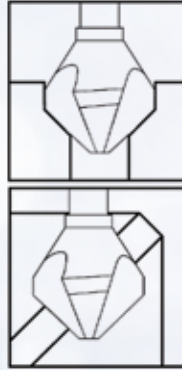

| D Overall Diameter (mm) | d Shank Diameter (mm) | Chamfer Range Min/Max (mm) | L Overall Length (mm) | Series 493A | |
|----------------------------------|--------------------------------|-------------------------------------|--------------------------------|----------------|-------|
| | | | | Code | Price |
| 4.3 | 4 | 1.3-4.3 | 40 | 541160 | 31.23 |
| 5.3 | 4 | 1.5-5.3 | 40 | 541161 | 32.34 |
| 6.0 | 5 | 1.5-6.0 | 45 | 541162 | 33.42 |
| 6.3 | 5 | 1.5-6.3 | 45 | 541163 | 33.42 |
| 8.0 | 6 | 2.0-8.0 | 50 | 541164 | 34.47 |
| 8.3 | 6 | 2.0-8.3 | 50 | 541165 | 34.47 |
| 9.4 | 6 | 2.2-9.4 | 50 | 541166 | 35.76 |
| 10.0 | 6 | 2.5-10.0 | 50 | 541167 | 36.45 |
| 10.4 | 6 | 2.5-10.4 | 50 | 541168 | 36.45 |
| 11.5 | 8 | 2.8-11.5 | 56 | 541169 | 40.94 |

| D Overall Diameter (mm) | d Shank Diameter (mm) | Chamfer Range Min/Max (mm) | L Overall Length (mm) | Series 493A | |
|----------------------------------|--------------------------------|-------------------------------------|--------------------------------|----------------|--------|
| | | | | Code | Price |
| 12.0 | 8 | 2.8-12.0 | 56 | 541170 | 44.23 |
| 12.4 | 8 | 2.8-12.4 | 56 | 541171 | 44.23 |
| 15.0 | 10 | 3.2-15.0 | 60 | 541172 | 51.77 |
| 16.5 | 10 | 3.2-16.5 | 60 | 541173 | 55.61 |
| 20.5 | 10 | 3.5-20.5 | 63 | 541174 | 63.60 |
| 25.0 | 10 | 3.8-25.0 | 67 | 541175 | 86.25 |
| 28.0 | 12 | 4.0-28.0 | 71 | 541176 | 113.20 |
| 30.0 | 12 | 4.2-30.0 | 71 | 541177 | 117.48 |
| 31.0 | 12 | 4.2-31.0 | 71 | 541178 | 119.70 |

TAP & DRILL SETS

FRACTIONAL/MACHINE SCREW & METRIC

- 16 piece sets (8 taps/8 drills) supplied in vinyl pouch
- Larger drill diameters which reduce tap breakage
- Supplied in vinyl storage case



Code 311526

126.36



Code 311527

212.88

| Taps (Plug) | Tap Drill |
|----------------|--------------|
| 6 - 32 | 7/64 |
| 8 - 32 | #29 |
| 10 - 24 | #23 |
| 10 - 32 | #20 |
| 1/4 - 20 | 13/64 |
| 5/16 - 18 | 17/64 |
| 3/8 - 16 | P |
| 1/2 - 13 | 7/16 |

| Taps (Plug) | Tap Drill (mm) |
|----------------|-------------------|
| M3 x 0.50 | 2.50 |
| M3.5 x 0.60 | 2.90 |
| M4 x 0.70 | 3.30 |
| M5 x 0.80 | 4.20 |
| M6 x 1.00 | 5.00 |
| M8 x 1.25 | 6.75 |
| M10 x 1.50 | 8.50 |
| M12 x 1.75 | 10.25 |

CUTTING FLUID



TAP
MAGIC

| | | |
|-----------------------|-------------|-------------------|
| XTRA-THICK 16oz. | Code 219238 | 18. ³⁹ |
| PROTAP 16oz. | Code 219217 | 17. ¹⁴ |
| AQUEOUS 16oz. | Code 219225 | 15. ⁵⁰ |
| ECO-OIL 16oz. | Code 219232 | 15. ⁰³ |
| EP-XTRA 16oz. | Code 219202 | 14. ⁶⁹ |
| ALUMINUM 16oz. | Code 219210 | 14. ⁶⁸ |

SAVE AT KAR

END MILLS | ALU-POWER

MICROGRAIN SOLID CARBIDE | 2 & 3 FLUTE | 42° & 45° HELIX



- For high velocity milling of aluminum and other non-ferrous materials
- Provides improved surface roughness
- Tightly controlled cylindrical margin

2 FLUTE | 42° HELIX | REGULAR LENGTH | "BANSHEE"

- Excellent plunging capabilities
- Excellent chip removal due to higher rake angle, higher helix angle (42°) and bigger chip pocket



Tolerance: 0/-0.0012

| Cutter Diameter (Inch) | Shank Diameter (Inch) | Length of Cut (Inch) | Overall Length (Inch) | Code | Price |
|------------------------|-----------------------|----------------------|-----------------------|--------|--------|
| 1/16 | 1/8 | 1/8 | 1-1/2 | 888310 | 36.65 |
| 3/32 | 1/8 | 1/4 | 1-1/2 | 888311 | 36.65 |
| 1/8 | 1/4 | 5/16 | 1-3/4 | 888312 | 42.47 |
| 3/16 | 1/4 | 7/16 | 2 | 888313 | 43.77 |
| 1/4 | 3/8 | 3/4 | 2-1/2 | 888314 | 60.31 |
| 5/16 | 3/8 | 13/16 | 2-1/2 | 888315 | 60.31 |
| 3/8 | 3/8 | 1 | 2-1/2 | 888316 | 61.45 |
| 7/16 | 7/16 | 1 | 2-3/4 | 888317 | 123.21 |

| Cutter Diameter (Inch) | Shank Diameter (Inch) | Length of Cut (Inch) | Overall Length (Inch) | Code | Price |
|------------------------|-----------------------|----------------------|-----------------------|--------|--------|
| 1/2 | 1/2 | 1 | 3 | 888318 | 112.75 |
| 1/2 | 1/2 | 2 | 4 | 888319 | 146.62 |
| 5/8 | 5/8 | 1-1/4 | 3-1/2 | 888320 | 229.38 |
| 3/4 | 3/4 | 1-1/2 | 4 | 888321 | 338.66 |
| 3/4 | 3/4 | 3 | 5-1/2 | 888322 | 440.15 |
| 1 | 1 | 1-1/2 | 4 | 888323 | 599.96 |
| 1 | 1 | 3 | 5-1/2 | 888324 | 779.86 |

3 FLUTE | 45° HELIX

- 3 flute and 45° helix allow harmonic balance at high speed conditions and smooth cutting
- Maximum material removal, chip evacuation, and stability



Tolerance: 0/-0.0005

REGULAR LENGTH



| Cutter Diameter (Inch) | Shank Diameter (Inch) | Length of Cut (Inch) | Overall Length (Inch) | Code | Price |
|------------------------|-----------------------|----------------------|-----------------------|--------|--------|
| 1/8 | 1/8 | 3/8 | 1-1/2 | 888409 | 39.88 |
| 3/16 | 3/16 | 9/16 | 2 | 888410 | 43.19 |
| 1/4 | 1/4 | 5/8 | 2-1/2 | 888411 | 48.58 |
| 5/16 | 5/16 | 5/8 | 2-1/2 | 888412 | 54.25 |
| 3/8 | 3/8 | 1 | 2-1/2 | 888413 | 63.13 |
| 7/16 | 7/16 | 1-1/4 | 2-3/4 | 888414 | 107.40 |
| 1/2 | 1/2 | 1-1/4 | 3 | 888415 | 117.51 |
| 5/8 | 5/8 | 1-5/8 | 3-1/2 | 888416 | 253.52 |
| 3/4 | 3/4 | 1-5/8 | 4 | 888417 | 313.92 |
| 1 | 1 | 2 | 5 | 888418 | 744.98 |

LONG LENGTH



| Cutter Diameter (Inch) | Shank Diameter (Inch) | Length of Cut (Inch) | Overall Length (Inch) | Code | Price |
|------------------------|-----------------------|----------------------|-----------------------|--------|--------|
| 1/4 | 1/4 | 1-1/4 | 3-1/4 | 888419 | 63.67 |
| 5/16 | 5/16 | 1-1/4 | 3-1/2 | 888420 | 73.73 |
| 3/8 | 3/8 | 1-1/2 | 3-1/2 | 888421 | 87.43 |
| 7/16 | 7/16 | 2 | 4 | 888422 | 134.19 |
| 1/2 | 1/2 | 2 | 4 | 888423 | 147.87 |
| 5/8 | 5/8 | 2-1/2 | 5 | 888424 | 338.23 |
| 3/4 | 3/4 | 3-1/4 | 6 | 888425 | 423.00 |
| 1 | 1 | 3-1/4 | 6 | 888426 | 811.85 |

WINTER WARMUP

BROACH SETS

STANDARD & HEAVY DUTY



- All Minute Man® Broach Sets are supplied in storage boxes, and come complete with precision broaches, slotted bushings, and necessary shims
- Collared bushings are recommended and are supplied unless plain bushings are specified on your order

TiN coated sets available on request

| Set Description | Code | Price |
|---|--------|---------------------------|
| No. 00 PRECISION SET: The most common keyway combinations for small keyways and bores. 3 broaches and 5 bushings = 15 keyway combinations (Collared bushings only) | 605500 | 586^{.93} |
| No. 10 STANDARD SET: Our best selling broach set. 4 broaches and 9 bushings = 18 keyway combinations (Collared bushings only) | 605501 | 1024^{.67} |
| No. 10A STANDARD SET: Same as No. 10 Set, but for sixteenth-sized bores. 4 broaches and 9 bushings = 18 keyway combinations (Collared bushings only) | 605502 | 1024^{.67} |
| No. 10-10A COMBINATION SET: Combines 10 and 10A sets features all bore sizes in 1/16 inch increments for keyways 1/8 to 3/8 inches. 4 broaches and 18 bushings = 36 keyway combinations (Collared bushings only) | 605503 | 1315^{.75} |
| No. 20 COMBINATION SET: Same as No. 10-10A combination set plus a 5/16" keyway for 11 extra combinations. 5 broaches and 18 bushings = 47 keyway combinations (Collared bushings only) | 605504 | 1516^{.35} |
| No. 40A SET: The most common keyway combinations for medium sized keyways and bores. 4 broaches and 8 bushings = 32 keyway combinations (Plain bushings only) | 605505 | 1919^{.92} |
| No. 40 SET: Same as No. 40A, but for sixteenth sized bores. 4 broaches and 8 bushings = 32 keyway combinations (Plain bushings only) | 605506 | 1919^{.92} |
| No. 40-1/2A HEAVY DUTY SET: The most common keyway combinations for large keyways and bores. 2 broaches and 6 bushings = 12 keyway combinations (Plain bushings only) | 605507 | 1978^{.66} |
| No. 40-1/2 HEAVY DUTY SET: Same as No. 40-1/2A but for sixteenth sized bores. 2 broaches and 6 bushings = 12 keyway combinations (Plain bushings only) | 605508 | 1978^{.66} |
| No. 50 HEAVY DUTY SET: Includes the most common keyway combinations for medium and large keyways. 3 broaches and 17 bushings = 29 keyway combinations (Plain bushings only) | 605509 | 3685^{.75} |
| No. 60 METRIC SET: The most common metric keyway combination for small keyways and bores. 2 broaches and 3 bushings = 6 keyway combinations (Collared bushings only) | 605510 | 469^{.71} |
| No. 70 METRIC SET: Our most popular metric broach set. 4 broaches and 13 bushings = 26 keyway combinations (Collared bushings only) | 605511 | 1205^{.86} |
| No. 80 METRIC SET: The most common metric keyway combination for medium-sized keyways and bores. 3 broaches and 12 bushings = 36 keyway combinations (Plain bushings only) | 605512 | 1888^{.11} |
| No. 90 METRIC SET: The most common metric keyway combination for large keyways and bores. 2 broaches and 8 bushings = 16 keyway combinations (Plain bushings only) | 605513 | 2541^{.10} |
| No. 100 HEAVY DUTY COMBINATION SET: The most complete set available including all popular combinations without duplication. Supplied in three wood boxes for convenient handling and storage, and comes with broaches, slotted bushings, and necessary shims. 9 broaches and 44 bushings = 102 keyway combinations (Collared bushings B & C; Plain bushings D & E) | 605514 | 6632^{.88} |

PRECISION MILLING MACHINE VISES

FCD-60 DUCTILE IRON



8 x 10 Inch | Code 277066

6 x 7.5 Inch | Code 277064

610^{.07}



6 x 8.9 Inch | Code 277065

662^{.75}



1364^{.53}



SAVE AT KAR



DEBURRING

MANGO II SET FR | RATCHET-BURR FOR ID

- Features FR ratchet holder, ideal for rotational chamfering, even when workspace is limited
- Inside diameter (ID) up to 0.79" (20mm)
- Deburrs steel, aluminum, copper, brass, cast iron, stainless steel and plastics



Code 550613

61.63

| Handle | Holder | Blades |
|--------|--------|--------|
| Mango | FR | F20 |

MANGO II SET BURR-EX | RACHET-BURR FOR OD

- Features FR ratchet holder, ideal for rotational chamfering, even when workspace is limited
- Outside diameter (OD) up to 1" (26mm)
- Deburrs steel, aluminum, copper, brass, cast iron, stainless steel and plastics



Code 550614

67.19

| Handle | Holder | Blades |
|----------|--------|--------|
| Mango II | FR | F26X |

B12 MODIFIED BLADE | SPECIAL BLADE FOR PLASTICS

**SIMILAR TO B25 BLADE!
MORE AGGRESSIVE CUT!**
HSS | Short-nosed
Fits B handles/holders



WHILE
QUANTITIES
LAST

79.99/box of 100

Code 550830 (individual)

SHAVIV EXCLUSIVELY AVAILABLE AT KAR IN CANADA

KNURLING TOOLS

MODEL M10 | STRAIGHT | FORM KNURLING



719.65
/each

- Recommended for RAA type knurling
- Straight knurling up to face
- High speed steel bushing
- Able to fit on right hand or left hand
- Wear resistant tool surface
- Adjustment of tool clearance angle by threaded studs integrated in the shank
- Supplied with a high speed steel hardened washer to prevent tool wear

| Model | Version | Capacity (mm) | Knurl Size (mm) | C (mm) | E (mm) | Weight (kg) | Spare Bushing/Washer Code | Code |
|--------------|---------|---------------|----------------------|--------|--------|-------------|---------------------------|--------|
| M10 25.10.20 | R+L | Ø8-200 | 25 x 10 x 11 (or 15) | 20 | 30 | 0.7 | 180198 | 180305 |
| M10 25.10.25 | R+L | Ø8-200 | 25 x 10 x 11 (or 15) | 25 | 35 | 0.8 | 180198 | 180307 |

FORM KNURLS | TYPE AA FOR MODEL M10 KNURLING TOOLS | HIGH SPEED STEEL



- Knurls according to DIN403 for knurlings as DIN82
- HRC 61±1 standard
- High speed steel
- Ground faces and central bore
- Knurls sold separately

93.37
/each

| Pitch (mm) | Size (mm) | Code | Pitch (mm) | Size (mm) | Code |
|------------|--------------|--------|------------|--------------|--------|
| 0.4 | 25 x 10 x 11 | 180310 | 1.2 | 25 x 10 x 11 | 180322 |
| 0.5 | | 180312 | 1.4 | | 180324 |
| 0.6 | | 180314 | 1.5 | | 180326 |
| 0.7 | | 180316 | 1.6 | | 180328 |
| 0.8 | | 180318 | 1.8 | | 180330 |
| 1.0 | | 180320 | 2.0 | | 180332 |

WINTER WARMUP

ELECTRONIC MEASURING MICROSCOPE

- Maximum working distance is 200" under WiFi mode
- May be connected to multiple iPads, Android devices or computers at the same time under WiFi mode
- Records photos and video
- Supplied with measuring software
- Magnification: 10X to 200X
- Pixels: 1.3M (resolution: 1280x1024)
- Built-in adjustable LED
- Power supply: built-in rechargeable battery

OPTIONAL ACCESSORIES:
Standard or Universal stand
Green, Yellow or Blue filters

Code 816685
463.⁸⁰



- Includes one of each:**
- Microscope
 - Base support
 - Focus support ring 80X/150X
 - Focus support ring 60X/200X
 - Calibration rule (graduation 0.004"/0.1mm)
 - Calibration rule (graduation 0.039"/1mm)
 - USB cable and software
 - AC/DC adaptor



| Magnification | Focus Distance (Inch) | View Field (Inch) | Accuracy (mil) |
|---------------|-----------------------|-------------------|----------------|
| 50x | 0.83 | 0.32 x 0.25 | 1.2 |
| 100x | 0.51 | 0.15 x 0.12 | 0.6 |
| 150x | 0.63 | 0.10 x 0.08 | 0.4 |
| 200x | 0.75 | 0.07 x 0.06 | 0.3 |

ELECTRONIC CALIPERS



COOLANT PROOF



- Resolution: 0.0005"/0.01mm
- Coolant proof, IP67 Ingress protection level
- Button functions: zero, on/off, inch/mm, ABS/REL, hold
- Battery CR2032
- Stainless steel
- Supplied in fitted storage case

0-6 Inch/0-150mm
Accuracy: ±0.0015"
Code 816018

197.³⁶

0-8 Inch/0-200mm
Accuracy: ±0.0015"
Code 280014

340.²⁵

0-12 Inch/0-300mm
Accuracy: ±0.0015"
Code 280015

394.⁴⁷



ABSOLUTE



- Absolute system
- Resolution: 0.0005"/0.01mm
- Buttons: Inch/mm, ABS/REL, on/off, origin set
- Battery CR2032
- Auto power off
- Data output
- Stainless steel
- Supplied in fitted storage case

OPTIONAL ACCESSORY: SPC cable

0-6"/0-150mm
Code 285127

74.⁴⁷

0-8"/0-200mm
Code 285128

104.⁶³

0-12"/0-300mm
Code 285129

187.³⁰

- Accuracy: ±0.0012"
- Designed for left-handed users
- Resolution: 0.0005"/0.01mm
- Buttons: on/off, zero, Inch/mm
- Battery CR2032
- Auto power off, move unit to turn power on
- Data output
- Stainless steel
- Supplied in fitted storage case



LEFT-HAND



OPTIONAL ACCESSORY: SPC cable

0-6"/0-150mm
Code 816615

219.⁸⁰

0-8"/0-200mm
Code 816616

260.¹⁵

0-12"/0-300mm
Code 816617

375.⁸³

ACCESSORY SET FOR ELECTRONIC CALIPERS



- Suitable for 0-6"/0-150mm and 0-8"/0-200mm electronic calipers (thickness of lower jaws ≤ 0.146")

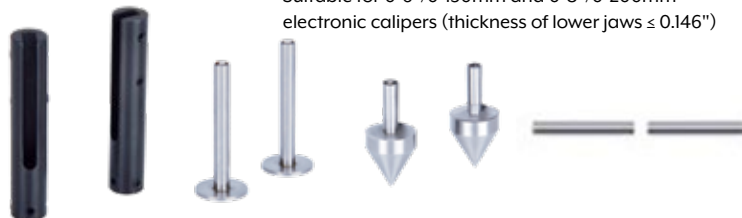

Code 877188

89.¹⁸

INSIZE EXCLUSIVELY AVAILABLE AT KAR IN CANADA

SAVE AT KAR

PIN GAGE HANDLES

- Wrench is needed to install pins
- Clamping bushes (0.2-714mm) are made of brass, clamping bushes (714-24.80mm) are made of aluminum



| Applicable pin gage diameter (mm) | Includes Handle and Clamping Bush (mm) | Code | Price |
|-----------------------------------|---|--------|---------------|
| 0.2-1.02 | 1 handle; 6 pairs (the clamping range are 0.2-0.38, 0.38-0.51, 0.51-0.64, 0.64-0.76, 0.76-0.89, 0.89-1.02) | 877417 | 37.55 |
| 1.02-1.91 | 1 handle; 7 pairs (the clamping range are 1.02-1.14, 1.14-1.27, 1.27-1.40, 1.40-1.52, 1.52-1.65, 1.65-1.78, 1.78-1.91) | 877434 | 40.24 |
| 1.91-3.33 | 1 handle; 8 pairs (the clamping range are 1.91-2.08, 2.08-2.26, 2.26-2.44, 2.44-2.62, 2.62-2.79, 2.79-2.97, 2.97-3.15, 3.15-3.33) | 877435 | 44.00 |
| 3.33-4.57 | 1 handle; 7 pairs (the clamping range are 3.33-3.51, 3.51-3.68, 3.68-3.86, 3.86-4.04, 4.04-4.22, 4.22-4.39, 4.39-4.57) | 877436 | 40.57 |
| 4.57-5.79 | 1 handle; 6 pairs (the clamping range are 4.57-4.78, 4.78-4.98, 4.98-5.18, 5.18-5.38, 5.38-5.59, 5.59-5.79) | 877437 | 43.17 |
| 5.79-7.14 | 1 handle; 6 pairs (the clamping range are 5.79-5.99, 5.99-6.20, 6.20-6.40, 6.40-6.63, 6.63-6.88, 6.88-7.14) | 877438 | 43.91 |
| 7.14-8.66 | 1 handle; 6 pairs (the clamping range are 7.14-7.39, 7.39-7.65, 7.65-7.90, 7.90-8.15, 8.15-8.41, 8.41-8.66) | 877439 | 51.48 |
| 8.66-10.31 | 1 handle; 6 pairs (the clamping range are 8.66-8.92, 8.9-9.17, 9.17-9.42, 9.42-9.70, 9.70-10.01, 10.01-10.31) | 877440 | 51.48 |
| 10.31-11.81 | 1 handle; 4 pairs (the clamping range are 10.31-10.67, 10.67-11.05, 11.05-11.43, 11.43-11.81) | 877441 | 48.73 |
| 11.81-12.95 | 1 handle; 3 pairs (the clamping range are 11.81-12.19, 12.19-12.57, 12.57-12.95) | 877442 | 42.53 |
| 12.95-14.71 | 1 handle; 4 pairs (the clamping range are 12.95-13.51, 13.51-13.89, 13.89-14.30, 14.30-14.71) | 877418 | 61.45 |
| 14.71-16.13 | 1 handle; 4 pairs (the clamping range are 14.71-15.09, 15.09-15.49, 15.49-15.88, 15.88-16.13) | 877419 | 61.45 |
| 16.13-17.88 | 1 handle; 4 pairs (the clamping range are 16.13-16.66, 16.66-17.07, 17.07-17.48, 17.48-17.88) | 877420 | 71.32 |
| 17.88-19.3 | 1 handle; 4 pairs (the clamping range are 17.88-18.26, 18.26-18.67, 18.67-19.05, 19.05-19.30) | 877421 | 71.32 |
| 19.3-24.8 | 1 handle; 8 pairs (the clamping range are 19.30-19.84, 19.84-20.62, 20.62-21.41, 21.41-22.23, 22.23-23.03, 23.03-23.80, 23.80-24.59, 24.59-24.80) | 877422 | 133.53 |

INSIZE EXCLUSIVELY AVAILABLE AT KAR IN CANADA

ER COLLETS | STEEL SEALED | INCH & METRIC



- Collet accuracy: 0.0003" to 0.0004" T.I.R. (0.008 mm to 0.010 mm)
- For optimal collet performance use tools with shank diameter equal to the collet nominal size
- Coolant allowable pressure: 1,500 PSI
- Made from high quality spring steel

BLOWOUT PRICING! 50% OFF!
WHILE QUANTITIES LAST!

| Description | Code | Price | Description | Code | Price | Description | Code | Price |
|-------------|--------|------------------------|-------------|--------|------------------------|-------------|--------|-------|
| ER16 3.5mm | 300841 | | ER25 5/32" | 312260 | | ER40 5/32" | 312332 | |
| ER16 7/32" | 312214 | | ER25 3/16" | 312261 | | ER40 3/16" | 312333 | |
| ER16 9/32" | 312216 | | ER25 7/32" | 312262 | | ER40 9/32" | 312336 | |
| ER16 11/32" | 312218 | | ER25 9/32" | 312264 | | ER40 5/16" | 312337 | |
| ER16 13/32" | 312220 | | ER25 11/32" | 312266 | | ER40 11/32" | 312338 | |
| ER16 4.5mm | 312223 | 21⁹⁹ | ER25 13/32" | 312268 | | ER40 13/32" | 312340 | |
| ER16 5.5mm | 312225 | each | ER25 15/32" | 312270 | | ER40 17/32" | 312344 | |
| ER16 6.5mm | 312227 | | ER25 17/32" | 312272 | | ER40 19/32" | 312346 | |
| ER16 7.5mm | 312229 | | ER25 19/32" | 312274 | | ER40 21/32" | 312348 | |
| ER16 8.5mm | 312231 | | ER25 3.0mm | 312276 | 24⁹⁹ | ER40 23/32" | 312350 | |
| ER16 9.5mm | 312233 | | ER25 4.0mm | 312277 | each | ER40 25/32" | 312352 | |
| ER20 5/32" | 312236 | | ER25 5.0mm | 312278 | | ER40 27/32" | 312354 | |
| ER20 7/32" | 312238 | | ER32 5/32" | 312291 | | ER40 29/32" | 312356 | |
| ER20 9/32" | 312240 | 22⁹⁹ | ER32 3/16" | 312292 | | ER40 31/32" | 312358 | |
| ER20 11/32" | 312242 | each | ER32 11/32" | 312297 | | ER40 4.0mm | 312360 | |
| ER20 15/32" | 312246 | | ER32 15/32" | 312301 | | ER40 5.0mm | 312361 | |
| ER20 5.0mm | 312250 | | ER32 17/32" | 312303 | | | | |
| | | | ER32 19/32" | 312305 | | | | |
| | | | ER32 23/32" | 312309 | | | | |
| | | | ER32 5.0mm | 312315 | | | | |

CONTACT YOUR LOCAL KAR DISTRIBUTOR FOR MORE DETAILS

WINTER WARMUP

LIVE CENTERS

HIGH SPEED STEEL – MAIN LINE | TYPE DA-N – STANDARD 60° WITH PRESSURE INDICATOR

APPLICATION: A pressure indicator with different colour bands permits rapid setting and monitoring of the optimum pressure. Length tolerances and different centre bores are compensated through a travel stroke at fixed positions. Correspondingly light work pieces can be clamped very finely.

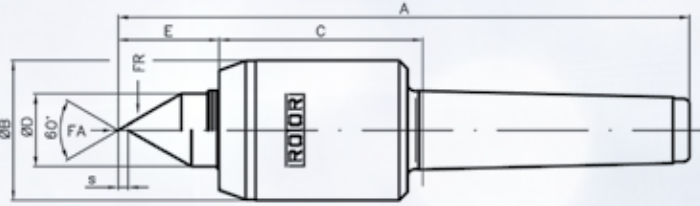

TYPE DA WITH PRESSURE INDICATOR AND LONG TRAVEL STROKE

Code 100090 **1195.98** Code 100091 **1195.98** Code 100092 **1339.01** Code 100093 **1750.67**

**ACCIDENT PREVENTION
WITH PRESSURE INDICATOR**

| Morse Taper | Model | FA daN | FR daN | A (mm) | ØB (mm) | C (mm) | ØD (mm) | E (mm) | S (mm) | Workpiece Maximum (kgs) | Max RPM | Code |
|-------------|--------|--------|----------|--------|---------|--------|---------|--------|--------|-------------------------|---------|--------|
| MT2 | 2 STD. | 11-110 | 24-240 | 136 | 34 | 53 | 14 | 19 | 2.7 | 190 | 7000 | 100090 |
| MT3 | 3 STD. | 20-200 | 40-420 | 174 | 42 | 62 | 22 | 31 | 3.0 | 440 | 5800 | 100091 |
| MT4 | 4 STD. | 23-230 | 50-500 | 209 | 53 | 72 | 28 | 34 | 4.3 | 900 | 4800 | 100092 |
| MT5 | 5 STD. | 80-800 | 150-1500 | 259 | 64 | 87 | 38 | 42 | 5.2 | 1850 | 4000 | 100093 |

CYLINDRICAL OPTION ALSO AVAILABLE. ASK YOUR LOCAL KAR DISTRIBUTOR FOR MORE DETAILS

SQUARE KEY STOCK



- Cold drawn oversize zinc plated - steel
- Tolerances for both dimensions:
 - up to 3/4" inc. 0.000" to +0.002"
 - over 3/4" to 1-1/2" inc. 0.000" to +0.003"
 - over 1-1/2" to 2-1/2" inc. 0.000" to +0.004"

| Size (Inch) | Code | Price | Size (Inch) | Code | Price |
|-------------|--------|-------|-------------|--------|--------|
| 3/32 | 455510 | 3.37 | 5/8 | 455522 | 13.24 |
| 1/8 | 455511 | 2.12 | 11/16 | 455523 | 15.29 |
| 5/32 | 455512 | 2.97 | 3/4 | 455524 | 17.27 |
| 3/16 | 455513 | 2.48 | 13/16 | 455525 | 17.80 |
| 7/32 | 455514 | 3.75 | 7/8 | 455526 | 20.48 |
| 1/4 | 455515 | 2.76 | 1 | 455527 | 28.07 |
| 9/32 | 455516 | 4.81 | 1-1/8 | 455528 | 51.11 |
| 5/16 | 455517 | 4.14 | 1-3/16 | 455529 | 57.73 |
| 3/8 | 455518 | 5.07 | 1-1/4 | 455530 | 66.06 |
| 7/16 | 455519 | 6.54 | 1-3/8 | 455531 | 74.21 |
| 1/2 | 455520 | 7.41 | 1-1/2 | 455532 | 88.66 |
| 9/16 | 455521 | 15.69 | 1-3/4 | 455533 | 122.17 |
| | | | 2 | 455534 | 174.49 |

CHUCK STOP SETS

STANDARD & DELUXE

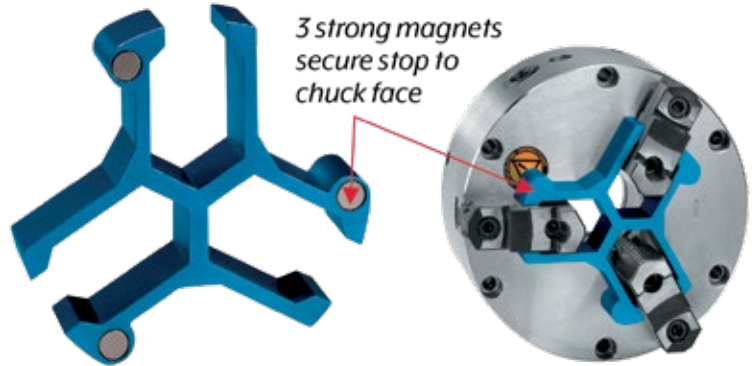

3 strong magnets secure stop to chuck face

3-Piece Standard Set
15, 20 and 25mm stops
Code 355985

537.90

5-Piece Deluxe Set
15, 20, 25, 30 and 35mm stops
Code 355986

935.92



KAR Industrial Inc.
www.kar.ca

Toronto.....1-800-387-3127
Montréal.....1-800-363-7862
Edmonton.....1-866-440-4326

Offer valid until March 31st, 2024

*Products shown may not be exactly as illustrated Code 000333

MAKING IT EASY TO DO BUSINESS WITH SINCE 1954... CONTACT YOUR LOCAL KAR DISTRIBUTOR TODAY!